

PART LIST 992.602

| CODE    | DESCRIPTION     | MATERIAL | Q.TY |
|---------|-----------------|----------|------|
| 06016F  | Sheave D060     | Various  | 2    |
| Y-BA052 | Cam-cleat kit   | Various  | 1    |
| Y-BA106 | Caps kit        | Various  | 2    |
| Y-BA177 | Swivel head kit | Various  | 1    |
| Y-BA178 | Cam-cleat kit   | S.Steel  | 1    |
| Y-BA495 | Sheave assy     | Various  | 1    |

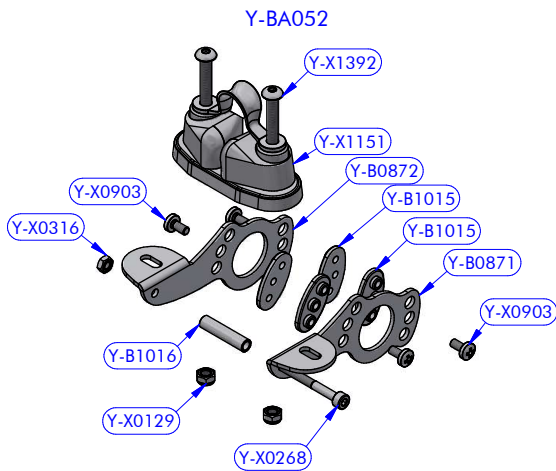

PART LIST Y-BA052

| CODE    | DESCRIPTION      | MATERIAL | Q.TY |
|---------|------------------|----------|------|
| Y-B0871 | Cam bracket      | S.Steel  | 1    |
| Y-B0872 | Cam bracket      | S.Steel  | 1    |
| Y-B1015 | Spacer           | Plastic  | 4    |
| Y-B1016 | Pipe spacer      | S.Steel  | 1    |
| Y-X0129 | Self-Locking nut | S.Steel  | 2    |
| Y-X0268 | Screw            | S.Steel  | 1    |
| Y-X0316 | Standard nut     | S.Steel  | 1    |
| Y-X0903 | Screw            | S.Steel  | 4    |
| Y-X1151 | Cam-Cleat        | S.Steel  | 1    |
| Y-X1392 | Screw            | S.Steel  | 2    |

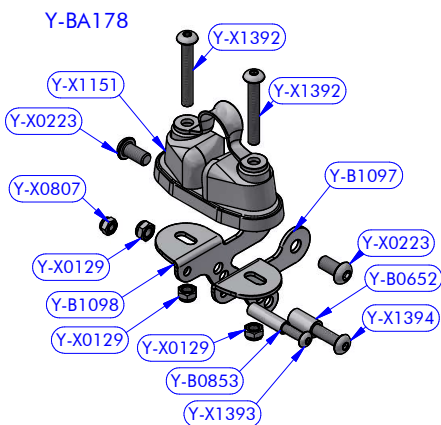

PART LIST Y-BA178

| CODE    | DESCRIPTION      | MATERIAL | Q.TY |
|---------|------------------|----------|------|
| Y-B0652 | Pipe spacer      | S.Steel  | 1    |
| Y-B0853 | Pipe spacer      | S.Steel  | 1    |
| Y-B1097 | Cam bracket      | S.Steel  | 1    |
| Y-B1098 | Cam bracket      | S.Steel  | 1    |
| Y-X0129 | Self-Locking nut | S.Steel  | 3    |
| Y-X0223 | Screw            | S.Steel  | 2    |
| Y-X0807 | Self-Locking nut | S.Steel  | 1    |
| Y-X1151 | Cam-Cleat        | S.Steel  | 1    |
| Y-X1392 | Screw            | S.Steel  | 2    |
| Y-X1393 | Screw            | S.Steel  | 1    |
| Y-X1394 | Screw            | S.Steel  | 1    |

**antal**

Main system Block series F4 D060  
Primary + Long head D06 L19,5 +  
Cam Cleat

DESCRIPTION

**992.602**

MODEL CODE

22/12/2022

DATE

00

REV.

20070903

DWG N.

1 / 2

PG.

06016F

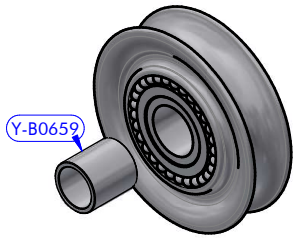

Y-BA492

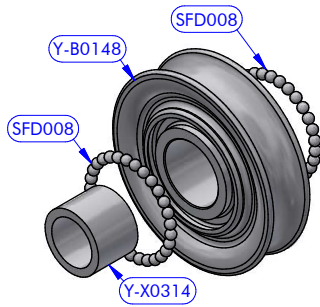

| PART LIST 06016F |             |          |      |
|------------------|-------------|----------|------|
| CODE             | DESCRIPTION | MATERIAL | Q.TY |
| Y-B0659          | Pipe spacer | S.Steel  | 1    |
| Y-BA492          | Sheave assy | Various  | 1    |

| PART LIST Y-BA492 |              |                 |      |
|-------------------|--------------|-----------------|------|
| CODE              | DESCRIPTION  | MATERIAL        | Q.TY |
| SFD008            | Delrin ball  | Plastic         | 58   |
| Y-B0148           | Resin        | POM-C           | 1    |
| Y-X0314           | C.F. Bushing | Composite Fibre | 1    |

03416M

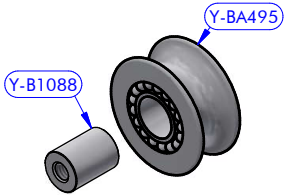

Y-BA495

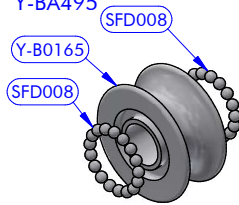

| PART LIST 03416M |               |          |      |
|------------------|---------------|----------|------|
| CODE             | DESCRIPTION   | MATERIAL | Q.TY |
| Y-B1088          | Threaded pipe | S.Steel  | 1    |
| Y-BA495          | Sheave assy   | Various  | 1    |

| PART LIST Y-BA495 |             |          |      |
|-------------------|-------------|----------|------|
| CODE              | DESCRIPTION | MATERIAL | Q.TY |
| SFD008            | Delrin ball | Plastic  | 34   |
| Y-B0165           | Resin       | POM-C    | 1    |

Y-BA177

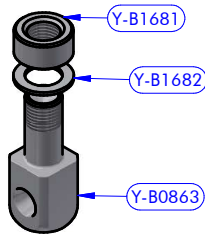

| PART LIST Y-BA177 |             |            |      |
|-------------------|-------------|------------|------|
| CODE              | DESCRIPTION | MATERIAL   | Q.TY |
| Y-B0863           | Swivel head | S.Steel HR | 1    |
| Y-B1681           | Nut         | S.Steel HR | 1    |
| Y-B1682           | Washer      | Tufnol     | 1    |

Y-BA106

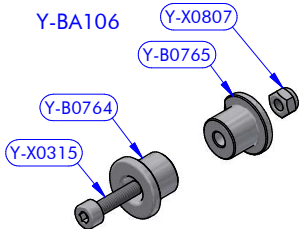

| PART LIST Y-BA106 |                  |           |      |
|-------------------|------------------|-----------|------|
| CODE              | DESCRIPTION      | MATERIAL  | Q.TY |
| Y-B0764           | Cap              | Aluminium | 1    |
| Y-B0765           | Cap              | Aluminium | 1    |
| Y-X0315           | Screw            | S.Steel   | 1    |
| Y-X0807           | Self-Locking nut | S.Steel   | 1    |

**antal**

Main system Block series F4 D060  
 Primary + Long head D06 L19,5 +  
 Cam Cleat

**992.602**

22/12/2022 00  
 DATE REV.  
 20070903 2 / 2  
 DWG N. PG.