

FB29 track

MOD. FB29.13 END FITTING

Made in plastic, should be attached to the mast with 2x8 mm screws.

MOD. FB29.12 JOINT

In order to ensure proper alignment the section of the track will be joined together with this nylon fitting: it is supplied with 2 screws.

MOD. FB29.15 INSTALLATION TOOL

It is necessary to position the slugs with the mast in vertical position; with tracks MOD. FB29.221.

SLUGS

Available on request, for 8 mm screws.

For boats from 80 to 100 ft

FB29 track is made for Fibreball system:

- MOD. FB29.190
page 169

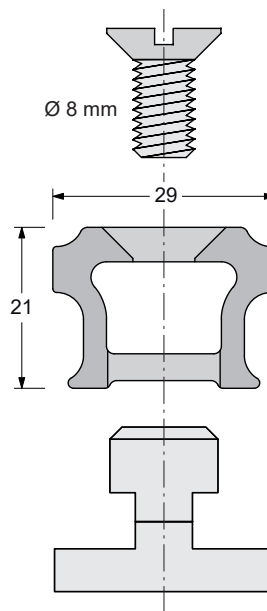

TRACK

Aluminium profile hard black anodized and teflon coated.

WEIGHT – 0.72 kg/m

MODEL	HOLE SPACING mm	LENGTH m
↓ DIRECT MOUNTING		
FB29.311	100	3
↓ SLUG MOUNTING, VERTICAL MAST		
FB29.221	100	2
↓ SLUG MOUNTING, HORIZONTAL MAST		
FB29.321	100	3

Direct mounting requires drilling and tapping holes in the mast, slug mounting does not.

MOD. FB29.11 LOADER

It allows the cars to be easily loaded and unloaded.

FIXING – 2xØ8 mm screws.
L – 300 mm
WEIGHT – 0.24kg

